



USER'S MANUAL

TRIMOS

V3 / V4 / V5

Electronic Height Gages



Dear customer, congratulations for choosing a TRIMOS measuring instrument. For more than 40 years, our products have built up an excellent reputation in terms of quality, accuracy and longevity. For full satisfaction with the present product, we recommend to read this user's manual carefully.

750 50 0045 03 Version 1.1 / 2015-04

Valable for firmware version V3.22

TRIMOS® - All modification rights reserved

TRIMOS SA
Av. de Longemalle 5
CH - 1020 Renens
T. + 41 21 633 01 01
F. + 41 21 633 01 02
www.trimos.ch



CONTENTS

1. Safety regulations	3
1.1 Important information.....	3
1.2 Security symbols.....	3
1.3 General warnings.....	3
2. Instrument description	4
2.1 Instrument.....	5
2.2 Interfaces/connectors.....	5
2.3 Display.....	5
3. Setting up	6
3.1 Packing list.....	6
3.2 Setting-up.....	7
4. Getting started	8
4.1 Displacement Modes : Manual/Motorized.....	8
4.2 Setting into operation.....	9
5. Main functions	11
5.1 Selection of height and diameter / centerline measurements.....	11
5.2 Height measurements.....	11
5.3 Diameter and centerline measurements.....	12
5.4 References.....	14
5.5 Selection of the resolution.....	14
5.6 Setting / memorizing of the probe constant.....	14
5.7 Selection of the measuring unit.....	15
5.8 Measuring in Min / Max / Delta mode.....	15
5.9 Average between 2 last measurements.....	17
5.10 Difference between 2 last measurements.....	18
5.11 Zero setting of the display.....	18
6. Secondary functions	19
6.1 Perpendicularity measurement.....	19
6.2 Inversion of the measuring direction.....	19
6.3 Probe Holder Change.....	20
6.4 Shrinking factor.....	21
6.5 Display modes.....	21
6.6 Manual recording of the probe constant.....	22
7. Data transfer and print-out	23
7.1 USB Connection.....	23
7.2 RS232 Connection.....	24
8. Configuration	25
9. Application and adjustments	28
9.1 Probing.....	28
9.2 Air Cushion (V4).....	28
9.3 Adjustment of floating probe suspension balancing.....	29
9.4 Replacement of battery block.....	29
9.5 Recycling of electronic components.....	29
9.6 Resetting of the instrument.....	30
9.7 Cleaning.....	30
10. After sales service	30
10.1 Complaints / repairs.....	30
10.2 Agents.....	30
11. Technical specifications	31
12. Dimensions	33

1. SAFETY REGULATIONS

1.1 Important information

In order to prevent any damages due to wrong manipulation, please carefully read the following instructions. TRIMOS will not accept any responsibility in case of damages caused by inadequate use not in line with the present manual.

1.2 Security symbols

The following security symbols are used in this manual:



General warning, utilisation advice



Risk of electric shock



Electrostatic protection

1.3 General warnings



Protection against electrostatic interferences:

Static electricity can damage the electronic components of the instrument. In order to prevent this type of damages, avoid any contact with the connector pins.



In order to prevent any changes of the instrument performance or any accident, the instrument should never be dismantled.



If, for any reason, the electronic unit has to be opened, only authorized personnel are allowed to do so.



Do not expose the instrument, its components and accessories to rain or any projection of fluids. Avoid penetration of foreign substances into the connectors and the instrument openings.



Do not cover or wrap the display unit during use. The unit must be kept well ventilated to avoid any overheating.



In case of problems with the instrument or any of its parts (no display, overheating, abnormal smell...), immediately switch off the instrument and disconnect the power supply. Please contact your local TRIMOS agent.



This is a high accuracy instrument. Particular care should be taken during its entire operational lifetime. Pay special attention to the following specific points :

- Use the instrument on a stable, smooth and clean surface plate.
- Avoid any shock to prevent the instrument from losing some or all of its performing characteristics.
- Use the instrument in a vibration free area.
- Avoid exposure to direct sunlight and excessive humidity.
- Avoid proximity of heating or air conditioning systems.
- Respect the advised environmental conditions.

2. INSTRUMENT DESCRIPTION

2.1



2.3

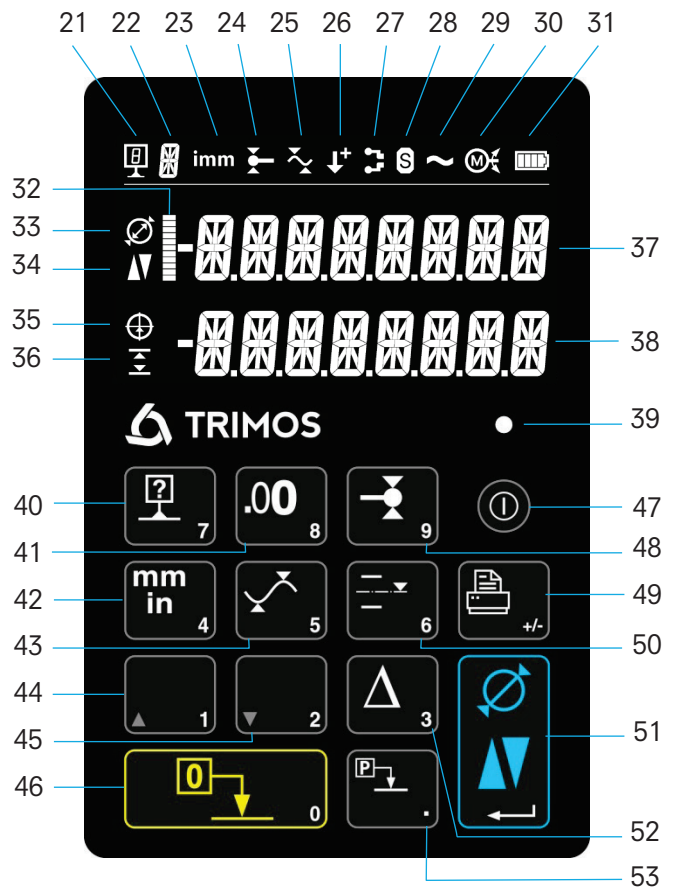

2.2

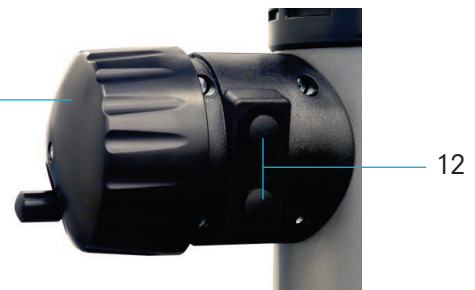
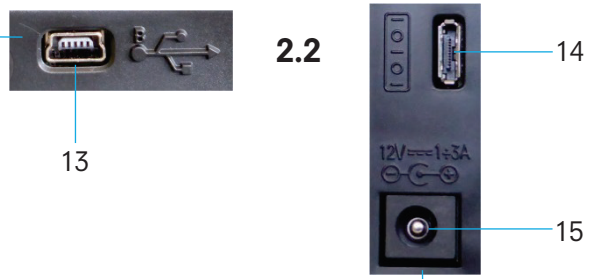

2.1 Instrument

1. Upper probe holder (V4 ÷ V5)
2. Screw for the adjustment of the floating probe suspension
3. Handle for carriage displacement
4. Transport safety screw for locking of probe suspension (chromium plated)
5. Lower probe holder
6. Insert holder
7. Measuring insert
8. Operating handle for the displacement of the instrument
9. Button for activation of air cushion and programmable functions keys (V4 ÷ V5)
10. Base with air cushion system for instrument displacement (V4 ÷ V5)
11. Handwheel for carriage displacement / Activation of manual/motorised movement (V4 ÷ V5)
12. Buttons for motorised displacement

2.2 Interfaces/connectors

13. Mini USB connector (on top of display unit)
14. Connector for RS232 communication (on lower right side of height gauge)
15. AC adaptor connection (on lower right side of height gauge)

2.3 Display

21. Number of current reference
22. Function indicator
23. Active measuring unit
24. Probe constant indicator
25. Min / Max / Delta mode indicator
26. Inversion of measuring direction indicator
27. Probe holder change indicator
28. Shrinking factor $\neq 1$ indicator
29. Direct display mode indicator
30. Motorisation indicator
31. Battery charge level indicator
32. Probing indicator
33. "Diameter/centreline" mode – Value of diameter indicator
34. Height measurement and probing direction indicator
35. "Diameter/centreline" mode – Value of centreline indicator
36. Tolerance limit/difference mode indicator
37. Upper display line
38. Lower display line
39. Visual signal of function activation
40. Selection of references / numeric function **7**
41. Selection of resolution / numeric function **8**
42. Selection of measuring unit (mm/inch) / numeric function **4**
43. Min, max or delta mode/ numeric function **5**
44. Up arrow / numeric function **1**
45. Down arrow / numeric function **2**
46. Zero setting of the display / numeric function **0**
47. On/Off key (power ON / OFF)
48. Storage of probe constant / numeric function **9**
49. Print-out of data / Function "+/-"
50. Average of last 2 measurements / numeric function **6**
51. Function key: Selection of height and diameter - centerline measurements / Validation key
52. Difference between last 2 measurements / numeric function **3**
53. Sets the display to the previously input preset value of the current reference / Function ".".

3. SETTING UP

3.1 Packing list

The standard packing of the instrument includes the following elements:

1. Instrument with display unit and measuring insert holder
2. Measuring insert
3. Setting gauge
4. Charging unit
5. User's manual
6. Calibration certificate



While unpacking, carry the instrument by lifting it by its displacement handle (8) and body. **In NO case should the instrument be carried by the handle for carriage displacement (3).** Keep the original packaging for future transportation.

If the instrument has been stored at a temperature below 5°C, wait a few hours before unpacking to prevent the instrument parts from condensation. Condensation can affect sensitive parts of the instrument.

3.2 Setting-up

After unpacking, prepare the instrument as follows:

1. Clean the pads positioned underneath the base using a clean cloth, slightly dampened with alcohol.
2. Position the instrument with care on a clean measuring plate.
3. Slide the measuring insert into the holder and lock it, using the knob. Take care to position the eccentric probes correctly.

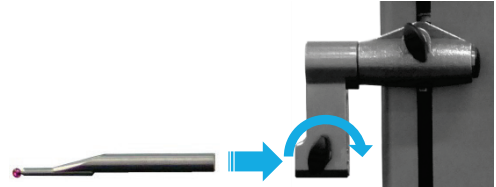

4. Release the transport safety screw (chromium-plated).

Note:

Do not try to remove the screw (screw stop)!



5. If the instrument does not switch on or in case of low battery level, proceed to a full loading of the batteries (plug in the charging unit to the instrument). Empty batteries are fully loaded in about 3 hours.



Only use the charging unit supplied with the instrument to load the batteries.

It is not necessary to wait until the battery pack is fully charged. The instrument becomes operational immediately after having connected the charging unit.

It is not dangerous to leave the charging unit connected. Permanently plugged-in instruments automatically switch to trickle charge mode.

The batteries are of Lithium-ion type. An excessive room temperature can affect the battery capacity and therefore the instrument autonomy. It is not recommended to load the battery in case of room temperature superior to 40C°.

Incorrect loading of the battery can result in a decrease of capacity, overheating, or even an explosion and cause important damages.

The charging units can be loaded and unloaded 300 times before a significant reduction of their capacity. The number of loading cycles and the autonomy can vary according to use and operating conditions.

4. GETTING STARTED

4.1 Displacement Modes : Manual/Motorized

V5 & V6 instruments can be used in manual or motorized mode.
V3 & V4 are manually operated only.

4.1.1 Manual Displacement Mode

V3 & V4

The manual displacement of the carriage is carried out with the help of the handle. This is the only possible displacement mode for V3 & V4.

V5

Push the handle inwards in order to pass into manual mode. In manual mode, V5 & V6 are used in the same way as V3 & V4.

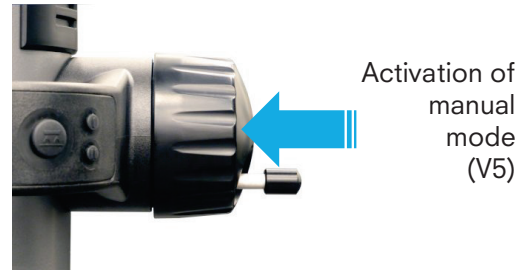

4.1.2 Motorized Displacement Mode (V5)

Pull the handle outwards to work in motorized mode. In this mode, the rotating handle can be tucked inside for ergonomic reasons.

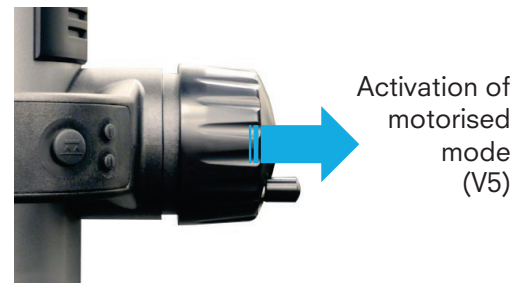

The motorized displacement is carried out with the 2 buttons situated behind the handle.

Rapid Displacement

A prolonged pression on one of the buttons causes a rapid movement in the chosen direction. The carriage will continue its displacement as long as the pressure is maintained.

Slow Displacement (Probing)

A short pressure causes a continuous displacement in probing speed, i.e. speed used for measuring. As soon as the probe gets in touch with a surface, a measurement is made.

Release of Probe

When the probe is in contact with the part (after probing), a short pressure on the button for the opposite direction allows to release the probe (ca. 0.5 mm).

Movement Stop

While displacing in low speed mode, a short pressure on the button for the same direction as that of the displacement will stop the movement.

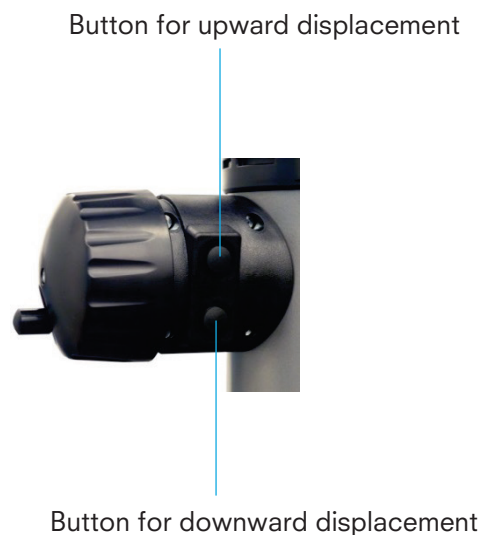

4.2 Setting into operation

1. Switch on the instrument by pressing button **On/Off** during 2 seconds. All segments of the display will light up.
Switch off the instrument by pressing the same button until the instrument turns off.



> 2 s

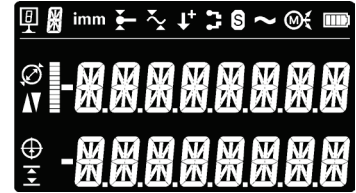

2. The display will ask for the reference position. Move the measuring carriage slowly across the mark indicating the reference position with the help of the handle for carriage displacement (the acquisition of reference is carried out by displacing the carriage upwards). An acoustic signal will confirm that the reference has been detected and the display starts counting. If the display does not start counting, repeat the sequence.

Note :

This procedure is automatically carried out in motorized mode (V5). The probe will position itself at the same level as the reference gauge (see opposite).

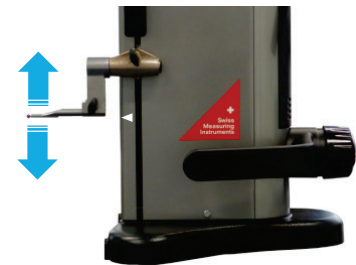
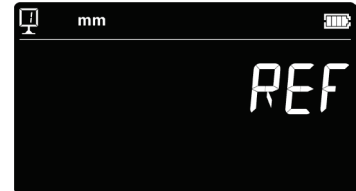

3. The instrument is now asking for the probe constant. This function compensates the dimension and the deflexion of the measuring insert when probing downwards and upwards (reversed surfaces, diameters). The last stored probe constant value will be displayed.



ou



Note 1 :

This procedure may be interrupted by pressing on the probe constant key or on the **Validation key**. The latest probe constant value measured is then recorded.

Note 2 :

The start mode can differ, according to the instrument configuration (§ 8).

- Use the setting gauge supplied with the instrument to carry out this operation.

Note:

A different setting gauge may be used. In this case, its dimension must be configured in the set-up menu (§ 8).

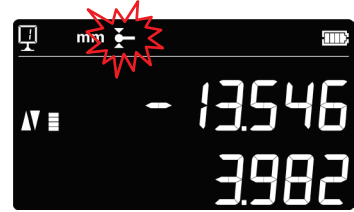

- Move the measuring insert downwards (use the handwheel for the displacement of the measuring carriage) until it touches the surface and an acoustic signal confirms the measurement (=probing).

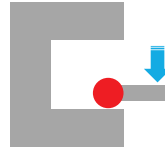

- Without moving any part (instrument and gauge), move the measuring insert towards the top and perform the same sequence on the upper surface of the setting gauge.

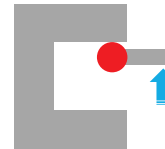

- Repeat the sequences 5 and 6 one more time. This allows establishing the probe constant more precisely.

2x

- The screen will display the setting gauge value during the latest probing, as well as that of the new probe constant. The instrument is then ready to be used.



In motorized mode (V5) this procedure can be automatically carried out by pressing the key opposite



The probe constant needs to be checked and stored again after each measuring insert change, after change of its position in the holder, after each adjustment of the measuring force or adjustment of the floating probe suspension.

5. MAIN FUNCTIONS

5.1 Selection of height and diameter / centerline measurements

To select the functions of height measurements or diameter/centreline distances, press the *Function key*. The corresponding symbol will be displayed.

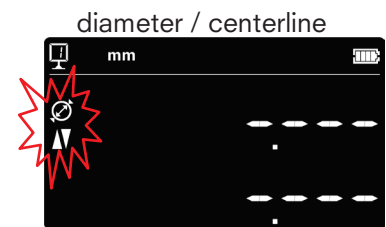

5.2 Height measurements

H1 = Height measurement downwards (▼)

H2 = Height measurement upwards (▲)

H12 = Chain dimensions

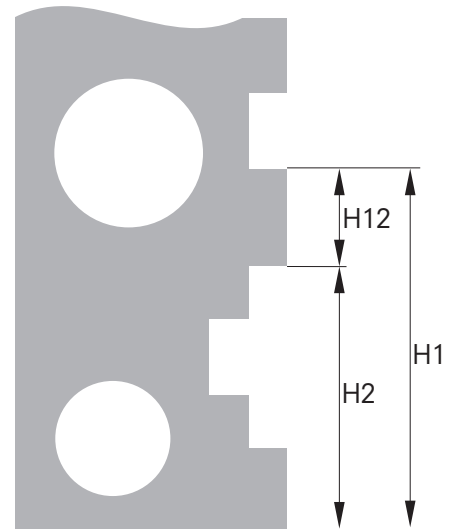

1. Select height measurement mode.



2. Set the display at zero or at a preset value with the measuring insert probing a reference surface (see § 5.11 and § 5.4.2).



3. Probe the surface to be measured downwards or upwards. The probing indicator will display the progression of the measuring force application. When the right force is reached, an acoustic signal will confirm the measurement.



Note:

The first line of the display indicates the height measured.

The second line indicates the distance from the former height measurement (chain of dimensions).

This display mode can be configured (§ 6.4).

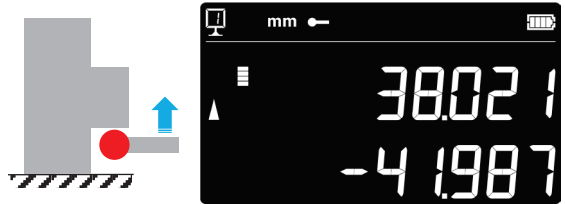

5.3 Diameter and centerline measurements

D = Diameter measurement (\varnothing)
 C = Centreline measurement (\oplus)

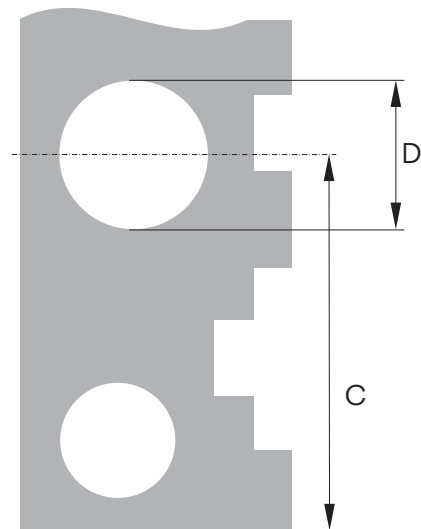

1. Set the display at zero or at a preset value on a reference surface (see § 5.11 and § 5.4.2).



ou



2. Select the diameter / centerline mode by pressing the **Function key**.

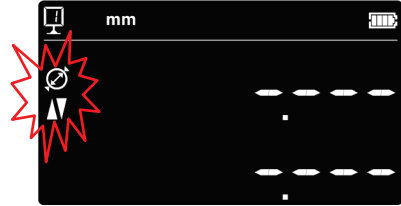

3a. **Internal diameter :**

Position the measuring insert into the bore and set it on the lower profile as near as possible to the reversal point (1). Engage the measuring force until the acoustic signal. Move the instrument (or the part) laterally to determine the reversal point (2). The reversal point is stored automatically.

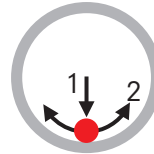

- 4a. Move the measuring insert straight up and set it on the upper profile as near as possible to the reversal point (3). Engage the measuring force until the acoustic signal. Move the instrument (or the part) laterally to determine the reversal point (4). Diameter and centreline values are displayed on the 1st and 2nd lines of the display respectively.

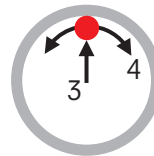

3b. **External diameter**

Set the measuring insert off center on the lower shaft profile as near as possible to the reversal point (1). Engage the measuring force until the acoustic signal. Move the instrument (or the part) laterally to determine the reversal point (2). It is automatically stored. Remove the measuring insert slowly to the side, off center (3).

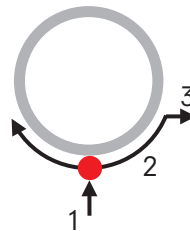

- 4b. Set the measuring insert on the upper shaft profile as near as possible to the reversal point (4). Engage the measuring force until acoustic signal. Move the instrument (or the part) laterally to determine the reversal point (5). Remove the measuring insert slowly to the side, off center (6). Diameter and centreline values are displayed on the 1st and 2nd lines of the display respectively.

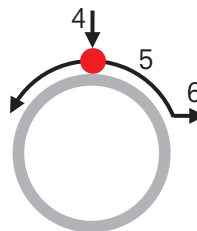

5. When the measuring insert is removed, the display remains frozen on the diameter and centerline values.
Restart with point 3a or 3b for a new measurement.

5.4 References

5.4.1 Selection of references

The use of references allows a parallel measurement starting from different points of origin (=references).

The current reference is mentioned at the top left hand side of the display. For reference change, press reference key and enter the reference number.

Note :

It is possible to choose the number of references (from 1 to 9). To configure the number of references, see § 8.

If the number of references is limited to 2, a simple pressure on the key will allow to pass from one reference to the other (no need to enter the reference No.).

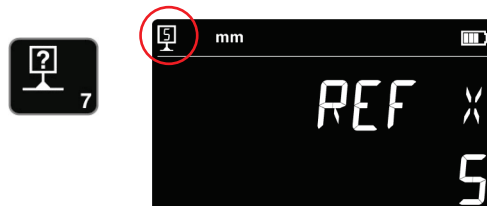

5.4.2 Assignment of a preset value to a reference

By pressing the Preset key, the previously entered preset value for each selected reference will be taken into consideration for height measurements, centerline distances or Min / Max values.

In direct mode (see § 6.4), the preset is executed at the current position of the probe.

A preset value can be assigned to each reference. Select the required reference and press the **Preset** key longer than 2 seconds. Enter the value and confirm by pressing the **Validation key**.



5.5 Selection of the resolution

To modify the display resolution, press key opposite



5.6 Setting / memorizing of the probe constant

To check and memorize the probe constant, press the following key and follow the same sequence as for "Setting into operation" (§ 4.1, points 4 to 8).

Note 1:

The current constant value is shown on the second line of the display by pressing this key once. A second pressure interrupts the acquisition of constant and brings the instrument back into height measuring mode.

The constant value of the probe can also be manually (§ 6.5).



or



5.7 Selection of the measuring unit



Measurements can be performed either in mm or in inch. To change the unit, press the *mm/in* key. The active unit is displayed on the top left of the display.

Note:

It is possible to lock in the required measuring unit (§ 8).

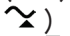

5.8 Measuring in Min / Max / Delta mode

Max = Measurement of maximum value ()
 Min = Measurement of minimum value ()
 Delta = Difference between Max and Min ()

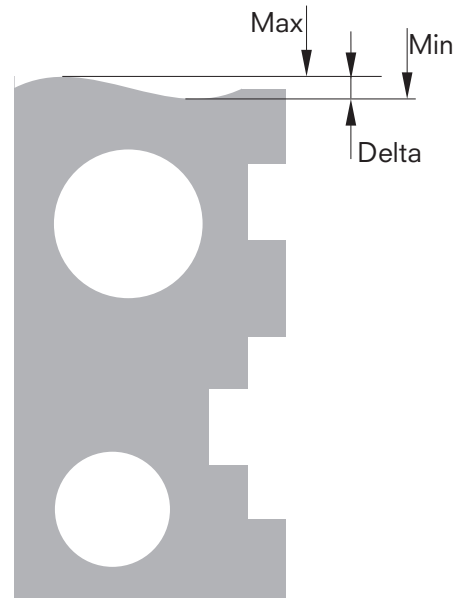

The measurements in mode Min, Max Delta have always to be done with the probe being in contact with the surface. It allows to determine the following values :

Min : Minimum value of the measured surface

Max : Maximum value of the measured surface

Delta : Difference between the maximum and minimum value

To select the Min, Max or Delta mode, press the key on the keyboard. By pressing the same key several times, the required mode will be displayed. To quit this mode, press the **Function key**.

Note:

The upper line of the display shows the current position, the lower line shows the extreme position of Min, respectively Max or Delta reached.



5.8.1 Measuring in Min or Max mode

1. Select Min or Max function. The corresponding indicator shows the activated mode.

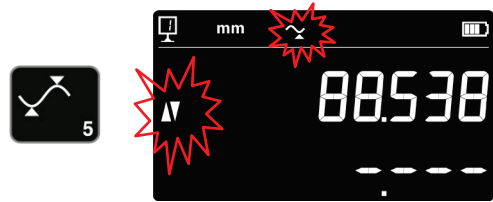

2. Probe the surface to be measured and displace the insert or the piece along the part to be analysed. The 1st line on the display shows the instantaneous position of the probe. The 2nd line indicates the minimum, respectively maximum value reached.

Note :

A zero setting or a preset reinitialize the display on the minimum or maximum value measured.

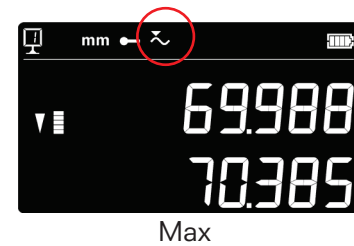
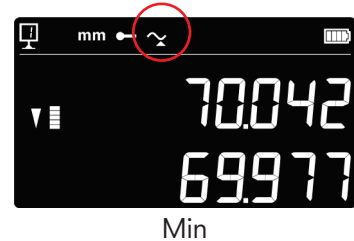

5.8.2 Measuring in Delta mode

1. Select Delta function. The corresponding indicator shows the activated mode.



2. Probe the surface to be measured and displace the insert or the piece along the part to be analysed. The 1st line on the display shows the instantaneous position of the probe. The 2nd line indicates the difference between the maximum and minimum (=Delta) measured.

Note :

By pressing the **Zero** key, the Delta mode will be reset and the display will show zero.



5.9 Average between 2 last measurements

By pressing this key, the average between the 2 last height measurements, centerline, Min or Max is determined. These various measurements can be combined with each other.



Averages :

M1 = Between 2 centerlines

M2 = Between 2 heights

M3 = Between Min et Max

M12 = Between centreline and height

M13 = Between centreline and Min or Max

M23 = Between height and Min or Max

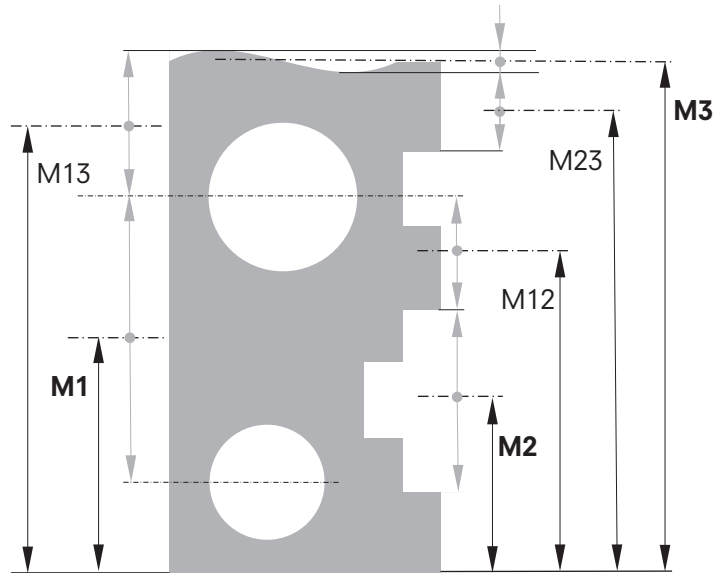

Note:

It is possible, after calculation of an average value, to give the calculated position a zero value or Preset value.



ou



5.10 Difference between 2 last measurements

By pressing the difference key, the distance between the 2 last height measurements, centerline, Min or Max is determined and mentioned on the 2nd line of the display. These various measurements can be combined with each other.



Distances:

D1 = Between 2 centerlines
 D2 = Between 2 heights
 D3 = Between 2 values Min-Min, Min-Max or Max-Max

D12 = Between centreline and height
 D13 = Between centreline and Min or Max
 D23 = Between height and Min or Max

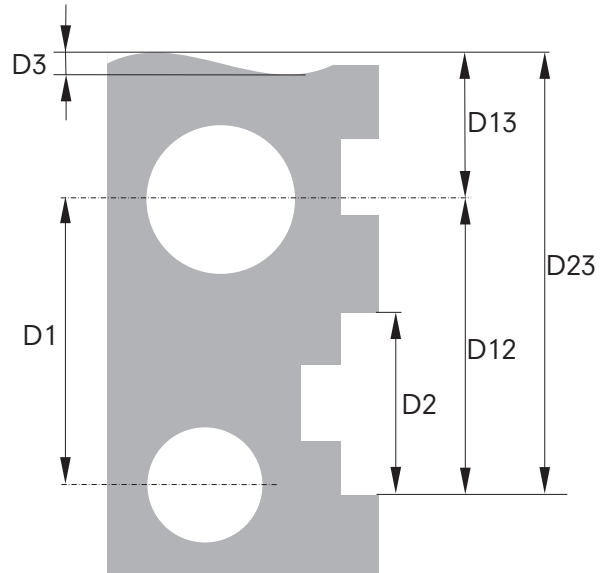

5.11 Zero setting of the display

In height measuring mode a zero setting will be done on the last surface measured by pressing the zero setting key.

In diameter / centerline mode a zero setting will be done on the last centerline distance measured.

In Min or Max mode a zero setting will be done on the last Min or Max value measured.



By pressing the key longer than 2 seconds, the preset value of the current reference will be displayed, disregarding the last probing step.

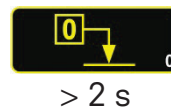

6. SECONDARY FUNCTIONS

6.1 Perpendicularity measurement

The carriage must be blocked before every perpendicularity measurement.



6.1.1 With a lever indicator

1. Mount a lever indicator in the insert holder.
2. Lightly press the lever of the indicator against the face to be measured and adjust zero.
3. Displace the carriage of the instrument vertically in order to check the perpendicularity of the face.



The base of the instrument **must be perfectly parallel to the face to be measured** in order to ensure an optimal precision .

6.2 Inversion of the measuring direction

It is possible to invert the measuring direction to obtain positive measuring values in both directions (upwards and downwards starting at zero). This function is mainly used when the part to be measured is higher than the measuring range of the instrument.

Press +/- key during 2 seconds to revert the direction of measurement. The inversion indicator of the measurement direction is mentioned as long as this mode remains active.

Preset

Immediately after having inverted the measuring direction, the preset value of the active reference will be replaced by the last measured value (height or centerline) before the inversion.

By pressing the *Preset* key, this last value will be displayed. Afterwards, the Preset value will be the initially entered one.



Procedure:

1. Perform measurements in a normal way
2. Turn the part when having reached the limit of the instrument range
3. Invert the measuring direction
4. Probe the last surface or centerline measured before
5. Press the **Preset** key (the last measured value will be displayed)
6. Continue measuring



Quit

Quit the function of inversion of the measuring direction by pressing once again the +/- key during 2 seconds

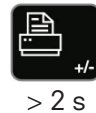

6.3 Probe Holder Change

This function allows to pass from one probe holder to another while keeping the same origin.
Press the key opposite during 2 seconds to activate the probe holder change function

Procedure to follow

1. Before taking out the insert probe a reference surface of centerline and activate the probe holder change mode. The function symbol is blinking.
2. Mount the probe on the other probe holder.
3. Probe the same surface again, or reference centreline.
4. Press **Preset** key (the display mentions the latest measured value).

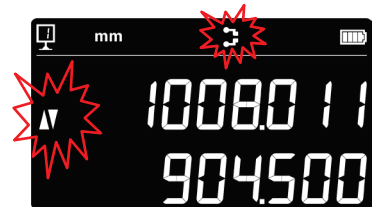
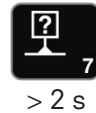

This procedure can be interrupted at any time by pressing the **Validate** key.

6.4 Shrinking factor

A shrinking factor can be entered here, for example for measuring injection moulds. This function allows in general "distending" or "shrinking" the measuring system by a defined factor.

To activate this function, press the key, shown at the right, during 2 seconds. Enter the shrinking factor (value between 0.7 and 1.2) and confirm by pressing *Validation Key*.

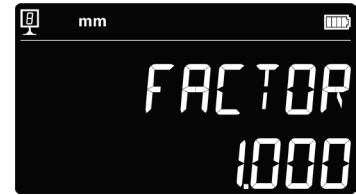
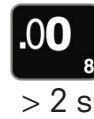

When the shrinking factor is different from 1, the following symbol appears at the top of the main display.



6.5 Display modes

In height measuring mode, 2 ways are possible to display the measured value :

"Standard" display

The upper line of the display permanently indicates the current position of the probe. It remains frozen at the measured value during probing.

During probing the lower line indicates the distance from the former height (Dimension in chain).

When the measuring force is released, this value is replaced by that of the last measurement.

"Direct" display

The upper line of the display permanently indicates the current position of the probe. It does not remain frozen during probing.

The lower line indicates the frozen value of the last measurement.

Activate the "direct" display mode by pressing the key opposite during 2 seconds. Do the same to deactivate this mode. When the "direct" display mode is activated, the symbol opposite appears at the top of the principal display.

Note:

The "standard" and "direct" display modes only apply to height measurements.



6.6 Manual recording of the probe constant

The probe constant can be introduced manually. To do so, press the opposite function key during 2 seconds and enter the requested value with the numeric keypad. Confirm by pressing the *Function* key.

The registered value is taken into account during measurements. Each new constant acquisition replaces the old one.



> 2 s



The constant is an essential element during bidirectional measurements. Great caution should be applied for the interpretation of the measurements results when this value is entered manually.

7. DATA TRANSFER AND PRINT-OUT

The instrument offers 2 communication ports:

Mini USB

This connector is placed at the back of the display unit. It allows a very simple connection to a PC for the transmission of data, upgrades, diagnosis, etc.

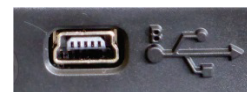

RS232

This connector is placed at the back of the height gauge. It allows a classic connection with external devices equipped with RS232 interfaces, such as printer or PC.



Measured values will be transferred in identical and simultaneous manner to both ports.

7.1 USB Connection

A mini-USB cable is required for the connection to a PC, as well as the communication software TrimosDataTransfer.

Cable

Cable USB A-Mini B: TA-EL-014 (ref. 332 02 0002)

Software

The software TrimosDataTransfer is freely available on www.trimos.ch, in the corresponding product section.

Data transfer procedure

1. Start TrimosDataTransfer
2. Connect the instrument to the PC with TA-EL-014 cable and wait for the connection to be established
3. Click on the application to which the data has to be transferred (i.e. Microsoft Excel)
4. Press **data transfer** key: the value is displayed at the place having the focus. Data can also be automatically transferred after each probing (§8).

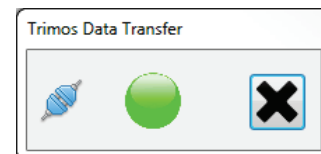

Format

Numerical value (as on display) in ASCII characters.
In diameter / centerline mode both values are separated by LF (Line Feed).

7.2 RS232 Connection

Data transmission

- Speed : 4800 baud
- ASCII Code : 7 bits
- Parity : even
- Stop bits : 2
- Handshake : without

Connection to printer

Thermal printer TA-EL-032 (Ref. 756 0018), includes RS232 cable, charging unit and support.

Connection to PC

Cable TA-EL-112 (réf. 333 0 0104)
Compatible with all RS232 software (WinDDE, HyperTerminal, WinWedge etc.)

Data transfer

The data transfer is made by pressing the *Data Transfer key*.

Format

Numerical value (as on display) in ASCII characters.
In diameter / centerline mode both values are separated by EOT (End Of Transmission).



Thermal Printer with support and RS232 cable



Cable RS232 for PC

8. CONFIGURATION

Various parameters of the instrument can be configured, Press the **Validation** key during 2 seconds to enter set-up menu

A simple pressure on **Validation key** validates the choice and allows passing on to the next menu.

Quitting the set-up mode is automatically made after passing the last menu. It is however possible to quit at any moment by pressing the **Validation key** during 2 seconds.



> 2 s

Measuring force adjustment

The measuring force can be electronically adjusted from 0.75 N to 1.5 N. To adjust, press the keys opposite.



Control of probe weight balancing

This function allows adjusting the balancing of the probe weight.

- a) Start-up display
- b) As soon as a movement of the carriage is detected, a numeric value corresponding to the position of the double carriage is displayed.
- c) The carriage is considered as balanced when **OK** is displayed in neutral position. The balancing procedure is described in § 9.3.

a)



b)



c)

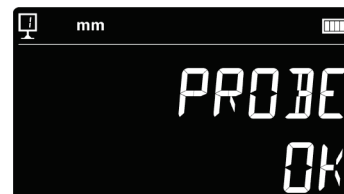

Number of references definition

The number of references available for the user can be defined (1 ÷ 9). To do so, press keys opposite.



Air cushion adjustment (V4 & V5)

The air flow of the pump can be adjusted according to the quality of the work table with the help of the keys opposite.

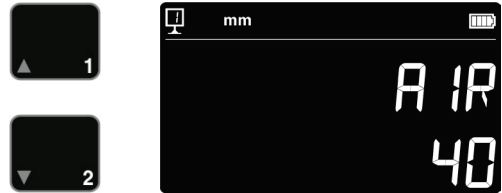

Programmable button 1 (V4 & V5)

Various functions can be attributed to programmable button 1:

- REF: change of reference
- PRESET: Preset
- ZERO: Zero setting (by default)
- PRINT: Data transfer (PRINT)
- SUR/DIA: Height/Diameter-centerline

Press the keys opposite to select the requested functions.



Programmable button 2 (V4 & V5)

Various functions can be attributed to programmable button 2:

- REF: change of reference
- PRESET: Preset
- ZERO: Zero setting
- PRINT: Data transfer (PRINT)
- SUR/DIA: Height/Diameter-centerline (by default)

Press the keys opposite to select the requested functions.



Port RS232

The RS232 port can be configured in 2 ways :

- PRINTER: Data transfer to printer or PC
- OPTO RS: Communication according to Opto RS standard

Press the keys opposite to select the requested functions.

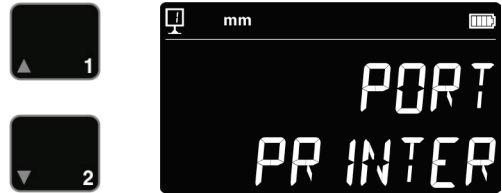

Data transfer mode

The transfer of measured values can be configured according to 2 modes :

- MANUAL: The transfer of the measured value is simply carried out by pressing the data transfer button.
- AUTO: The measured value is automatically transferred after each probing.

Press opposite button to select requested mode.



Unit blocking

The active unit can be blocked. Therefore it will not be possible to change it in work mode.
To block the function, select "LOCK" with the help of the keys opposite. To release it, select "UNLOCK".



Size of reference gauge

If the measuring insert calibration has to be made with another reference gauge than that delivered with the instrument, the height of the gauge can be entered with the help of the numeric keypad.



Standby mode

The instrument can switch to standby mode after a predefined time (5 ÷ 120 min).
To define time before standby, press keys opposite. "OFF" means that the instrument will never switch to standby mode.



Acoustic signal level

The acoustic signal level can be adjusted with the keys opposite.

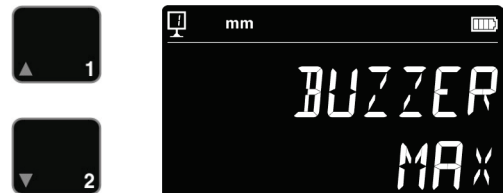

Function after start-up

The function immediately available after starting-up of the instrument can be selected with the keys opposite.

- CONST: Constant (by default)
- SUR: Height mode
- DIA: Diameter-centerline mode
- DELTA: Delta mode
- MAX: Max mode
- MIN: Min mode



Serial number

This function gives the serial number of the instrument.



Firmware version

This function gives the serial number of firmware.



9. APPLICATION AND ADJUSTMENTS

9.1 Probing

The measurement precision is directly linked to the quality of contact between the probe and the part to be measured (⇒ probing). The instrument offers all tools allowing an optimal probing:

Probing indicator

Situated on the left of the measured value, it views the probing zone (1).

If the probing zone has been passed, the display shows -.-.- and an acoustic signal rings out as long as the indicator remains out of the probing zone.

Probing direction indicators

Besides the acoustic signal, the measurement is visually confirmed by the indicators of the probing direction (2) and by the probing symbol (3).

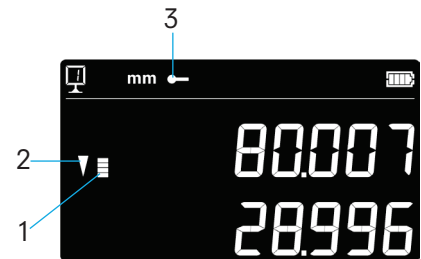

Acoustic signal

An acoustic signal confirms a correct measurement probing movement (measuring force set) and that the value has been taken.

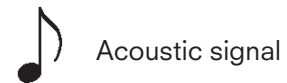

9.2 Air Cushion (V4)

The use of the air cushion facilitates the displacement of the instrument on the granite plate. The activation of the air cushion lifts the instrument at some μm . The air cushion is not only used for the displacement of the instrument in general but also when performing measurements (e.g. diameters). The main application is found particularly in industrial fields with large heavy parts. Small parts can be moved without activating the air cushion. This allows to significantly increase the autonomy of the instrument.

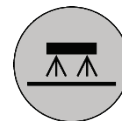

The air cushion force can be adjusted in the set-up menu (§ 8). It should be set on the minimum value allowing a comfortable displacement of the instrument.



When using the air cushion displacement for measurement procedures, all functions e.g. zero or preset setting of the display should be done with air cushion to take into consideration the lifting amount of the instrument.

9.3 Adjustment of floating probe suspension balancing

In order to guarantee a constant measuring force in both directions (upwards and downwards), it is necessary to adjust the balancing of the floating probe suspension according to the probe in use.

The adjustment button of the floating suspension (1) allows compensating the weight of the probe in use.

A function facilitating the balancing can be found in the set-up menu (§ 8).

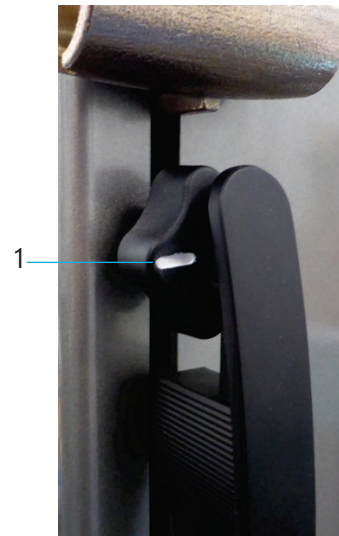

9.4 Replacement of battery block

When the instrument autonomy is not sufficient anymore, the battery block must be replaced :

1. Get a battery block from your TRIMOS agent (Trimos réf.: 3704 0021).
2. Open the lid at the back of the display.
3. Remove the old battery block and replace it by the new one (pay attention to the connector polarity).
4. Close the lid tightly.
5. Load the new batteries.

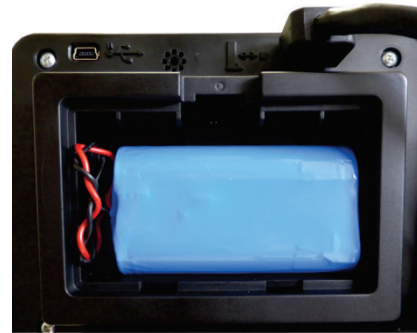

9.5 Recycling of electronic components



Disposal of Waste Electrical and Electronic Equipment (WEEE) applicable throughout the European Union and other European countries with separate collection programs

This symbol, found on the product or its packaging, indicates that it should not be treated as household waste. It should be handed over to an official collection point for the recycling of electrical and electronic equipment. A correct recycling of this product will help to preserve the environment and the natural resources. For more detailed information about the recycling of this product, please contact your local authorities or your TRIMOS supplier.

9.6 Resetting of the instrument

In case of blocking, it is possible to force the resetting of the electronics. To do so, open the lid at the back of the display and press the Reset button (1) with the tip of a pencil.

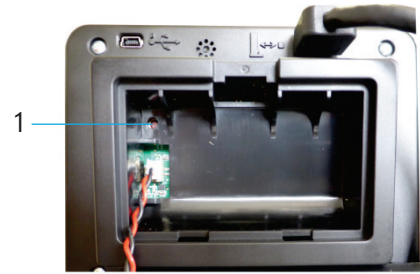

9.7 Cleaning

The plastic parts, the display unit as well as the painted parts of the instrument should be cleaned using a slightly dampened (watered) fabric. Clean the air cushion pads using a clean fabric, slightly dampened with alcohol.



The use of solvents such as acetone, white spirit, trichloethylene, petrol or others for cleaning must absolutely be avoided!

10. AFTER SALES SERVICE

10.1 Complaints / repairs

In case of problems, please contact your local TRIMOS agent.
For any transport, use the original packing or an adequate one.

10.2 Agents

You can find the official TRIMOS agents list on the website www.trimos.ch

11. TECHNICAL SPECIFICATIONS

V3		400	700
Measuring range	mm (in)	407 (16)	711 (28)
Application range	mm (in)	508 (20)	812 (32)
Max. permissible errors, bidirectional, B_{MPE}	μm	7	8
Repeatability, R_{MPE}	μm	2 (\varnothing : 4)	2 (\varnothing : 4)
Overall perpendicularity deviation (frontal), S_{MPE}	μm	10	15
Max. resolution	mm (in)	0.001 (0.00005)	
Measuring force	N	0.75 ÷ 1.5	
Autonomy	h	40	
Data output		USB / RS232	
Air cushion		No	
Protection grade of measuring system (CEI 60529)		IP67	
Weight	kg	21	24
Max. weight of measuring insert & holder	g	400	
Max. manual displacement speed	m/s	1	
Operational temperature	$^{\circ}\text{C}$	+10 .. +40	
Storage temperature	$^{\circ}\text{C}$	-10 .. +40	
Relative humidity (operation & storage)	HR	5 ÷ 75 % (non-condensing)	

V4		400	700
Measuring range	mm (in)	407 (16)	711 (28)
Application range	mm (in)	719 (28)	1023 (40)
Max. permissible errors, bidirectional, B_{MPE}	μm	5	7
Repeatability, R_{MPE}	μm	2 (\varnothing : 4)	2 (\varnothing : 4)
Overall perpendicularity deviation (frontal), S_{MPE}	μm	10	15
Max. resolution	mm (in)	0.001 (0.00005)	
Measuring force	N	0.75 ÷ 1.5	
Autonomy	h	40	
Data output		USB / RS232	
Air cushion		Yes	
Protection grade of measuring system (CEI 60529)		IP67	
Weight	kg	21	24
Max. weight of measuring insert & holder	g	400	
Max. manual displacement speed	m/s	1	
Operational temperature	$^{\circ}\text{C}$	+10 .. +40	
Storage temperature	$^{\circ}\text{C}$	-10 .. +40	
Relative humidity (operation & storage)	HR	5 ÷ 75 % (non-condensing)	

Note:

The above values have been determined according to ISO 13225.

These are valid with the standard probe (TA-MI-101), at a temperature of $20 \pm 0.5^{\circ}\text{C}$ and a relative humidity of $50 \pm 5\%$.

R_{MPE} is defined as twice the standard deviation (2s) over 20 measurements.

V5		400	700	1100
Measuring range	mm (in)	407 (16)	711 (28)	1110 (43)
Application range	mm (in)	719 (28)	1023 (40)	1422 (56)
Max. permissible errors, bidirectional, B_{MPE}	μm	2.5 + L(mm)/300		
Repeatability, R_{MPE}	μm	2		
Overall perpendicularity deviation (frontal), S_{MPE}	μm	5	8	11
Max. resolution	mm (in)	0.001 (0.00005)		
Measuring force	N	0.75 ÷ 1.5		
Autonomy	h	40		
Data output		USB / RS232		
Air cushion		Yes		
Protection grade of measuring system (CEI 60529)		IP67		
Weight	kg	21	24	33
Max. weight of measuring insert & holder	g	400		
Max. manual / motorized displacement speed	mm/s	1000 / 70		
Operational temperature	°C	+10 .. +40		
Storage temperature	°C	-10 .. +40		
Relative humidity (operation & storage)	HR	5 ÷ 75 % (non-condensing)		

Note:

The above values have been determined according to ISO 13225.

These are valid with the standard probe (TA-MI-101), at a temperature of 20 ± 0.5 °C and a relative humidity of $50 \pm 5\%$.

R_{MPE} is defined as twice the standard deviation (2s) over 20 measurements.

12. DIMENSIONS

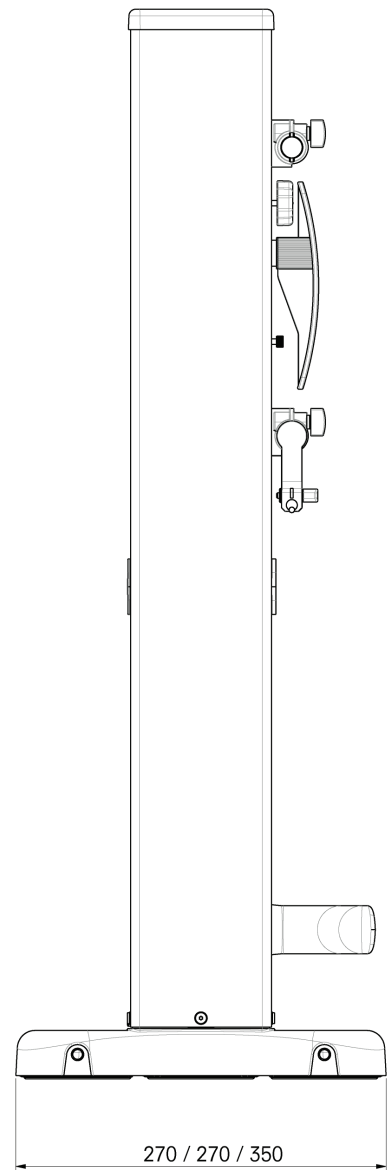
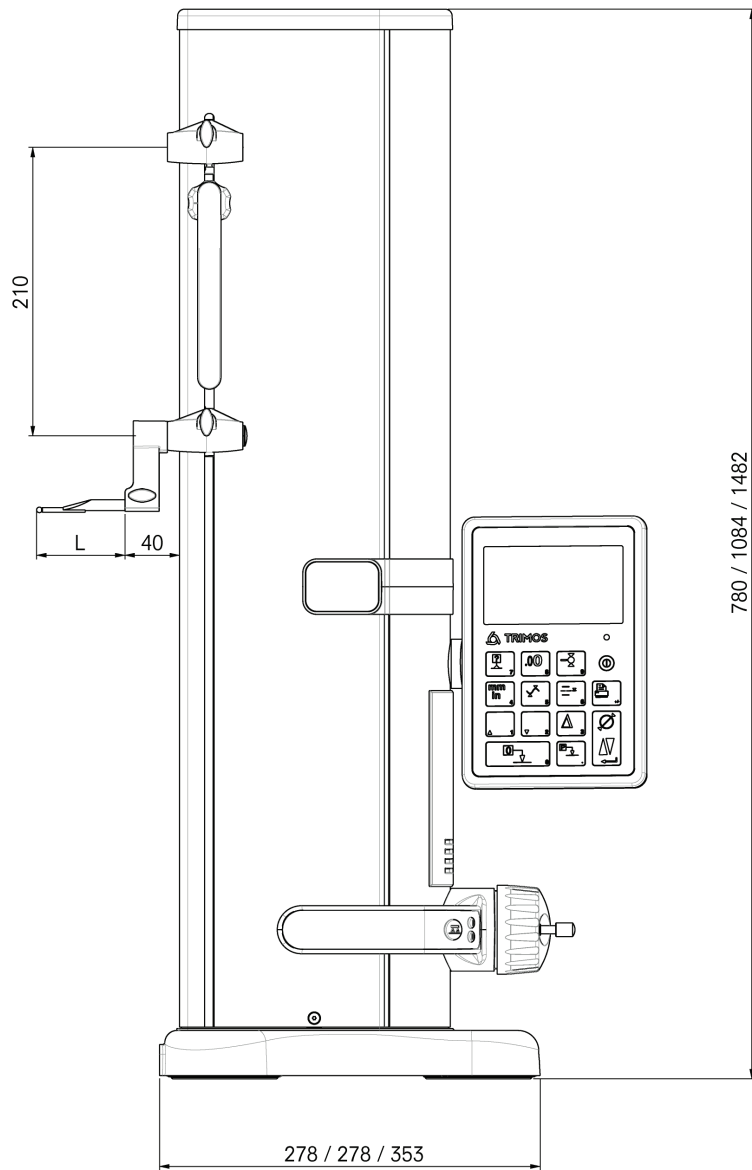

L: depends on the measuring insert used



Fowler High Precision



@Fowler_Co



Fowler High Precision



H I G H P R E C I S I O N

66 Rowe Street • Newton • Massachusetts 02466
(800) 788-2353 • (617) 332-4137 fax
www.fowlerprecision.com • sales@fvfowler.com

